

圖 面 標 準 格 式

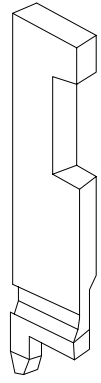

HT211

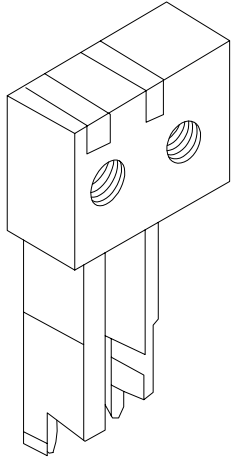

HT211A

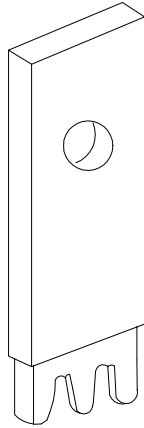

HT212A

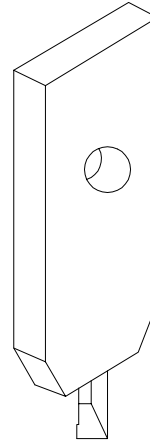

HT213

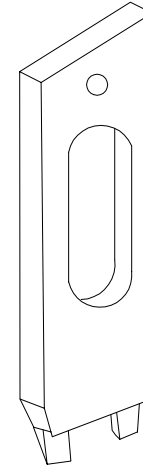

HT214

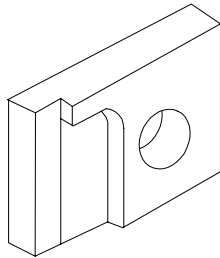

HT215

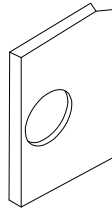

HT216

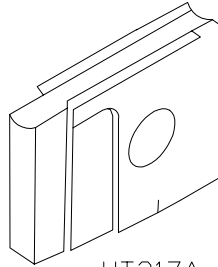

HT217A

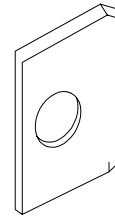

HT216

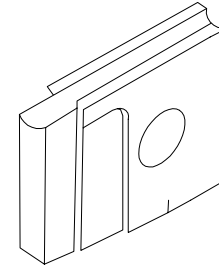

HT217A

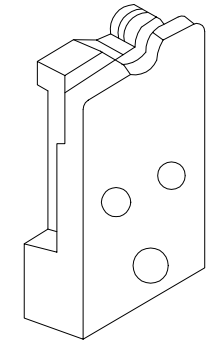

HT218

HO TIEN PRECISION INDUSTRY CO., LTD.
合田精密工業股份有限公司

KITANI - AUTOMATIC MACHINE TOOLING

| RECORD OF REVISION/ 修定內容 | | REV.BY/ 修定者 | REV.DATE/ 修定日期 | PART NO./ 品名 | | APPROVED BY/ 核准 | |
|--------------------------|--|-------------|----------------|-----------------|-----|-----------------|-------------------|
| | | | | MATERIAL/ 材質 | | CHECKED BY/ 審查 | |
| | | | | TREATMENT/ 表面處理 | | DRAWN/ 繪圖 | |
| | | | | CUSTOMER/ 客戶品名 | | DATE/ 製圖日期 | |
| | | | | UNIT/ 單位 | M/M | SCALE/ 比例 | DRAWIN TYPE/ 圖面種類 |